

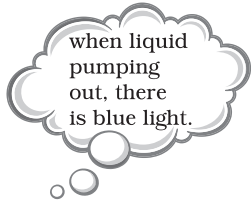

TOUCH-FREE



400ML



5CM is the best distance

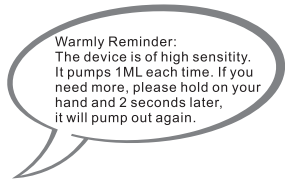

## Automatic Soap Dispenser

## Electric Auto Soap Dispenser

### Operation Instructions

1. Please rotate the cover on the bottom of the product. Insert 4 AAA 1.5V batteries and then close the cover.
2. Press the button on the bottom. You will see the light is flashing. Now the device is normal working.

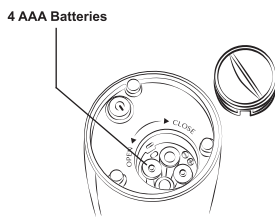
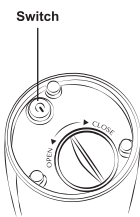

3. Open upper case on the body to add the liquid.

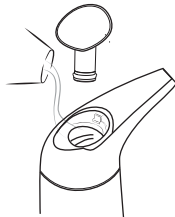

4. For the first time you use, please try a few times first. Then the liquid will fill the hose and then will come out.
5. The distance between your hands to the sensor is around 5CM. Each time it will pump out around 1ML liquid. If you need more liquid, please hold on your hand and wait for around 2 seconds. Then more liquid will come out soon.

### Cautions

1. When the liquid level is low, please add liquid. Otherwise the dispenser will not pump out any liquid.
2. When light is flashing, it means battery low. Please change the batteries.
3. Please do NOT shake the devices to avoid any serious damage.
4. Please take out the battery if long time no use.
5. Please make sure the liquid cover is well mounted. Otherwise the liquid will come out.
6. This devices is design for bathroom and kitchen.
7. Please do NOT place the device in water to avoid any damage.
8. Please do NOT place the device in direct sunshine to avoid any damage.
9. Normal working temperature is 3°C~40°C.